

LANDSCAPE CHARACTER

The landscape vision is to provide a high quality public realm improving accessibility and fostering the outlook onto the River Brent and Syon Park. Upgrades to both the street frontage and canal walkway are key to an inviting and accessible public realm.

The site is characterised by 3 key landscape areas:

Entrance Courtyard

A verdant entrance courtyard provides an inviting sense of arrival and enhances the street frontage with greening and trees along Ham Wharf road.

Central Playspace

Central to the public realm is a play space set within amenity lawn and planting. The play accommodates ages 0-4 with numerous play opportunities. Defensive planting along private terraces provide privacy and screening to the dwellings whilst providing the playspace with a sense of enclosure and greening to the public realm.

The Canal Side

The canal facing space of the scheme will provide social amenity for residents and the greater community. Seating will provide opportunities for people to gather and relax whilst taking in the south facing views of the River Brent and Syon Park.

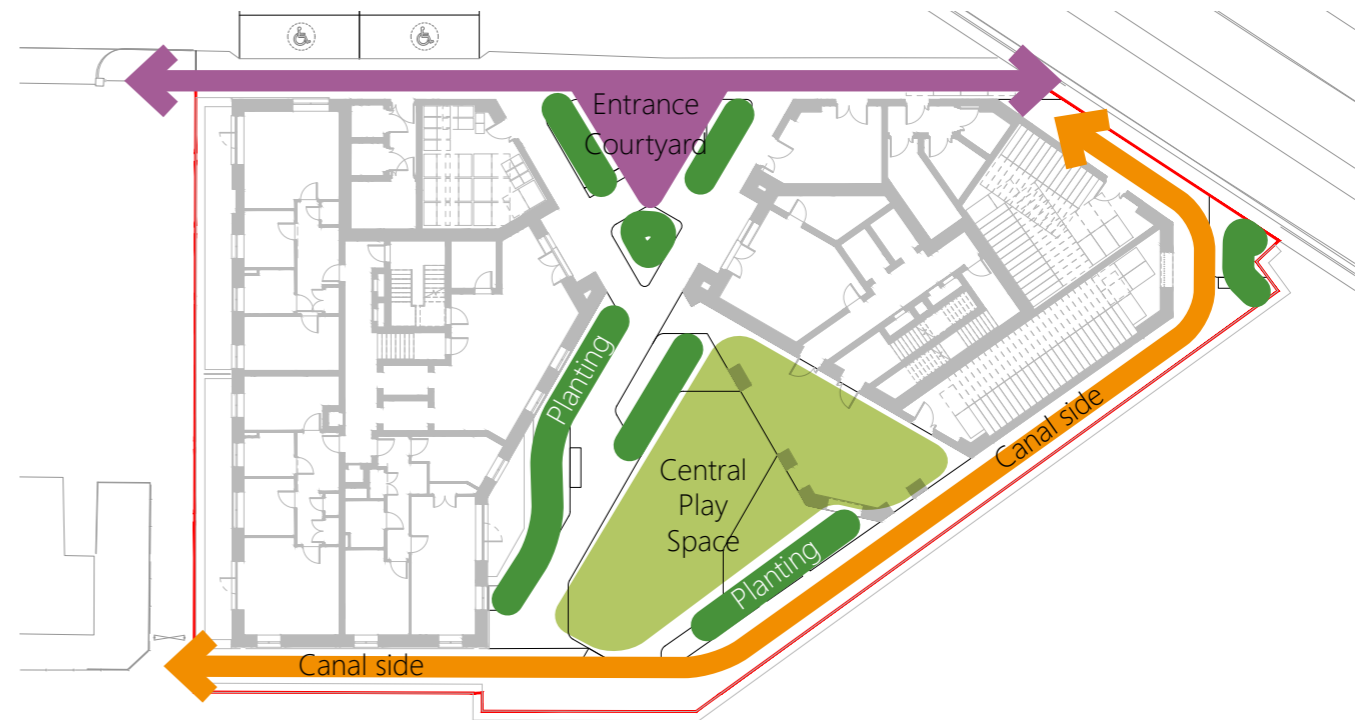

ENTRANCE COURTYARD



CANAL SIDE WALKWAY



HAM WHARF STREET FRONTAGE