

Recent Award Winning Peabody Schemes:

Fish Island Village:



- 600 new homes + commercial
- London Borough of Tower Hamlets
- Architects Haworth Tompkins, Pitman Tozer and Lyndon Goode
- WINNER – Overall Grand Prix award
- WINNER – Best Large Development
- HIGHLY COMMENDED – Best Regeneration Project

Stonelea Gardens:



- 79 homes
- London Borough of Waltham Forest
- Alan Camp Architects
- WINNER – Best Shared Ownership Home
- WINNER – Best Family Home
- WINNER – Best House

Silchester:



- 112 homes + commercial space
- Royal Borough of Kensington & Chelsea
- Haworth Thompson Architects RIBA London Award Winner
- RIBA National Award Winner

St John's Hill:



- 153 homes
- London Borough of Wandsworth
- Hawkins Brown Architects
- RIBA London Award Winner



RAILWAY LINE

BEDFONT LANE

HOUNSLOW ROAD

HOUNSLOW ROAD

LONGFORD RIVER

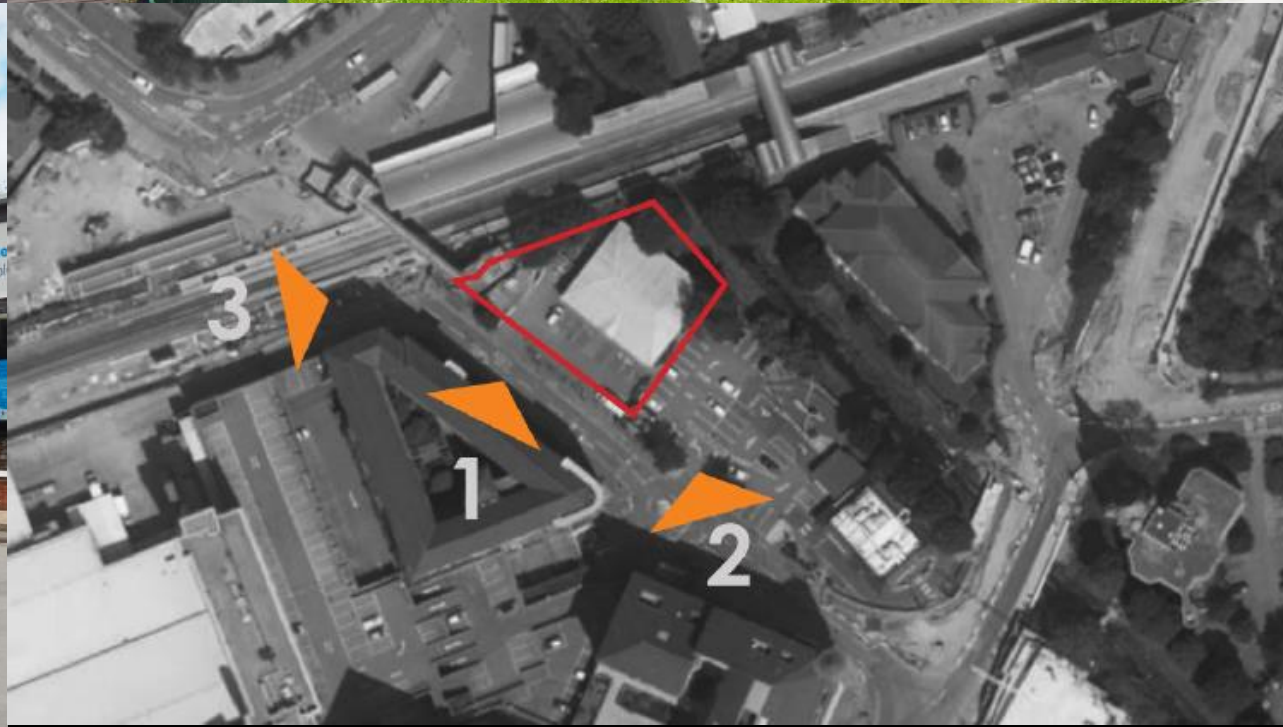

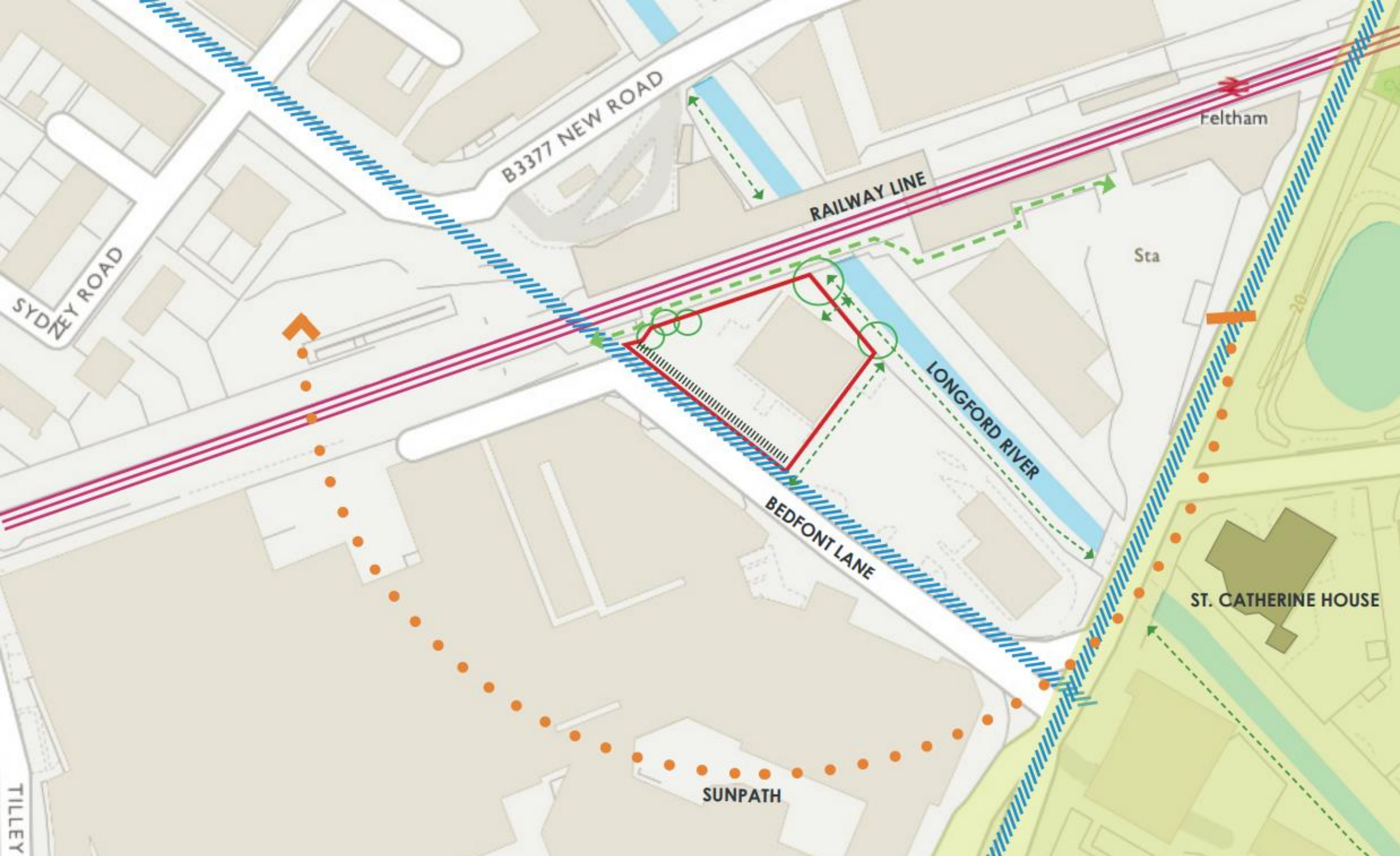

B3377 NEW ROAD

SYDNEY ROAD

RAILWAY LINE

Feltham

Sta

LONGFORD RIVER

BEDFONT LANE

ST. CATHERINE HOUSE

SUNPATH

TILLEY

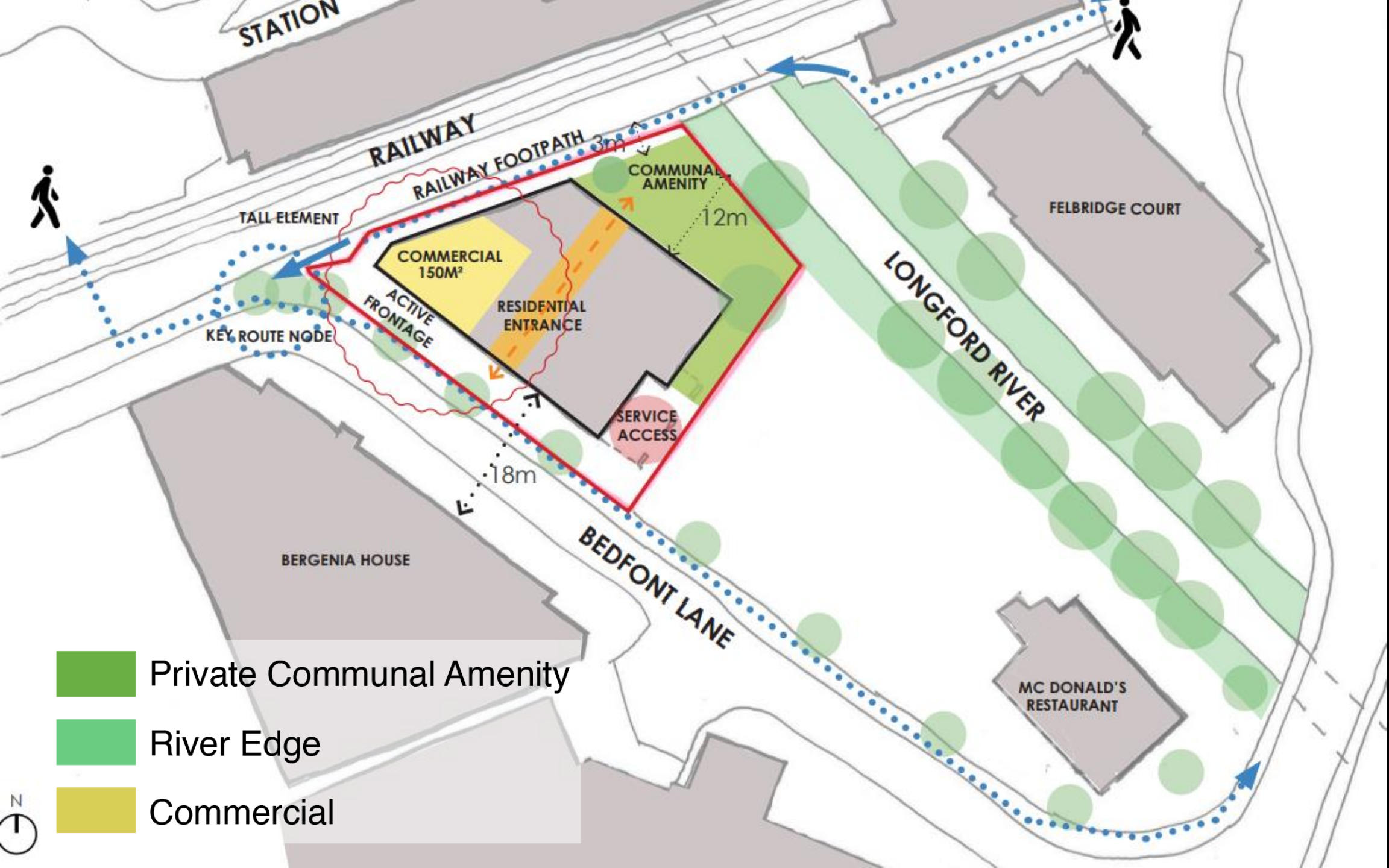

- Private Communal Amenity
- River Edge
- Commercial

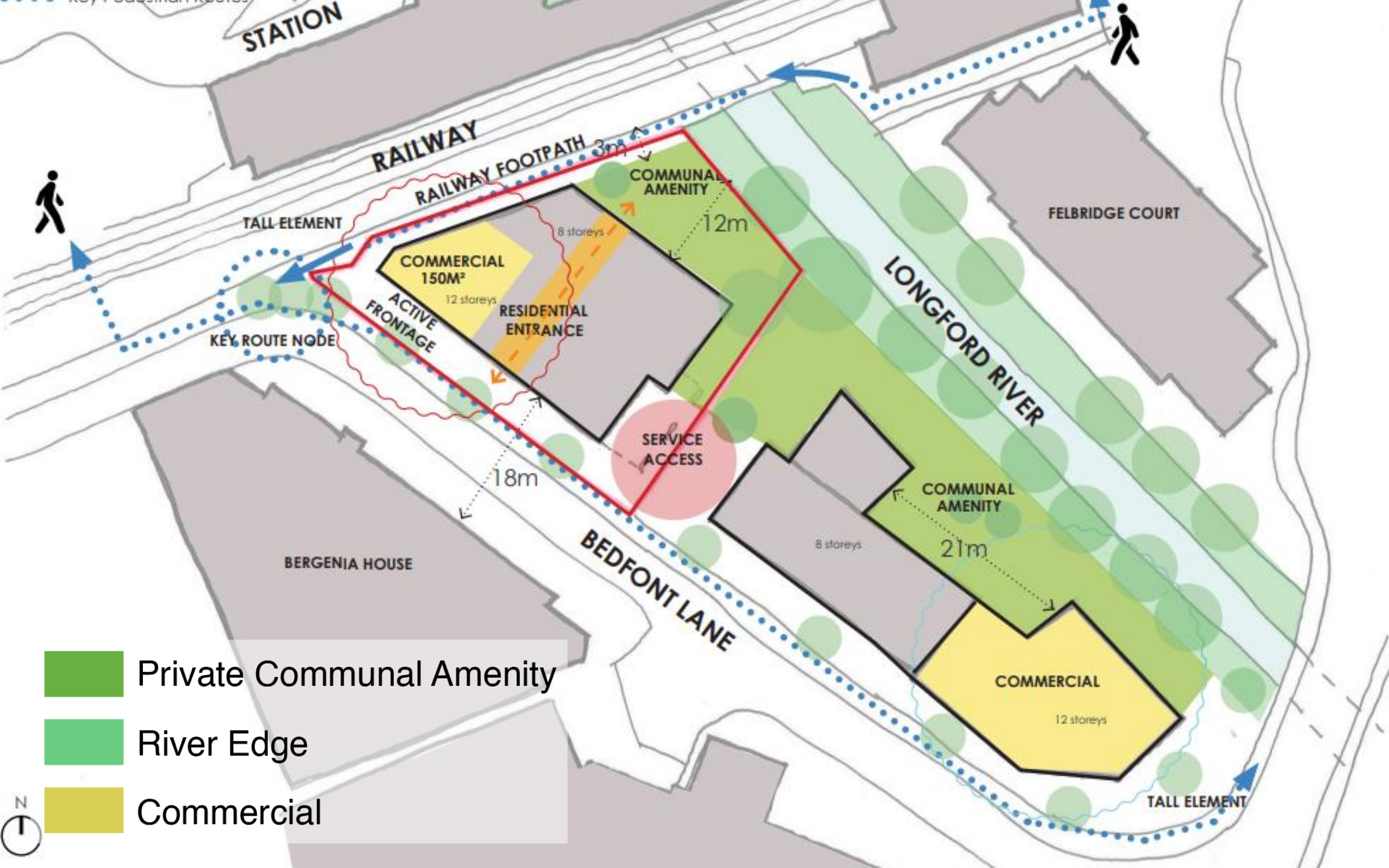

- Private Communal Amenity
- River Edge
- Commercial





Ground floor



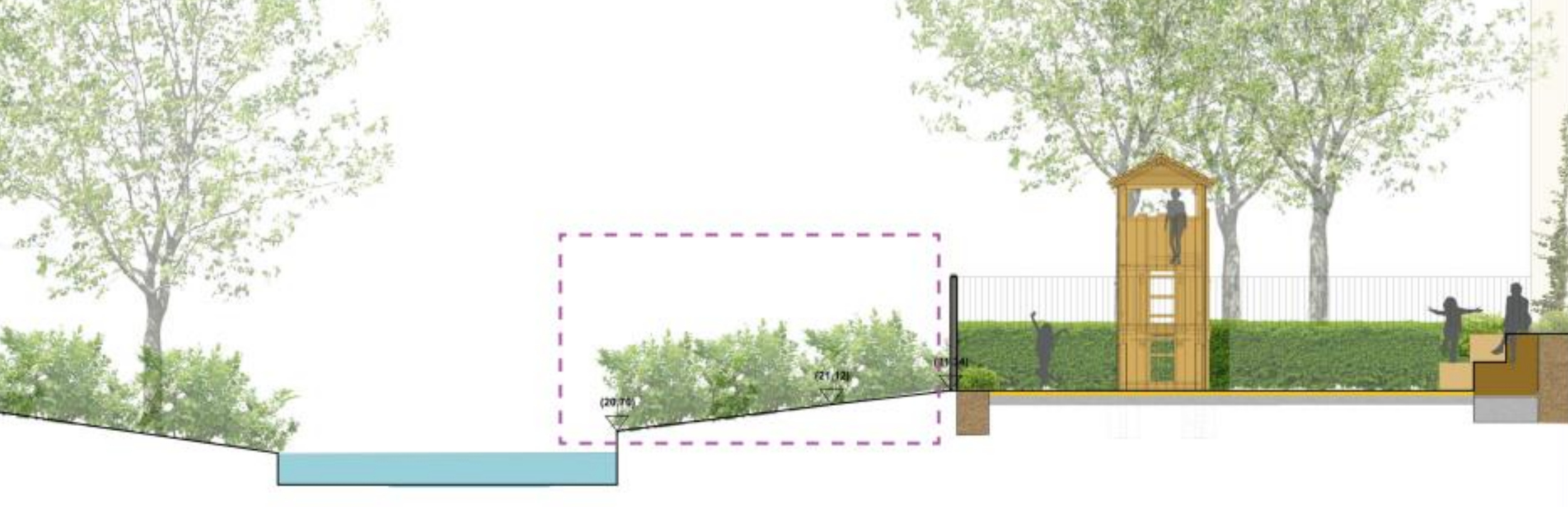

Building edge

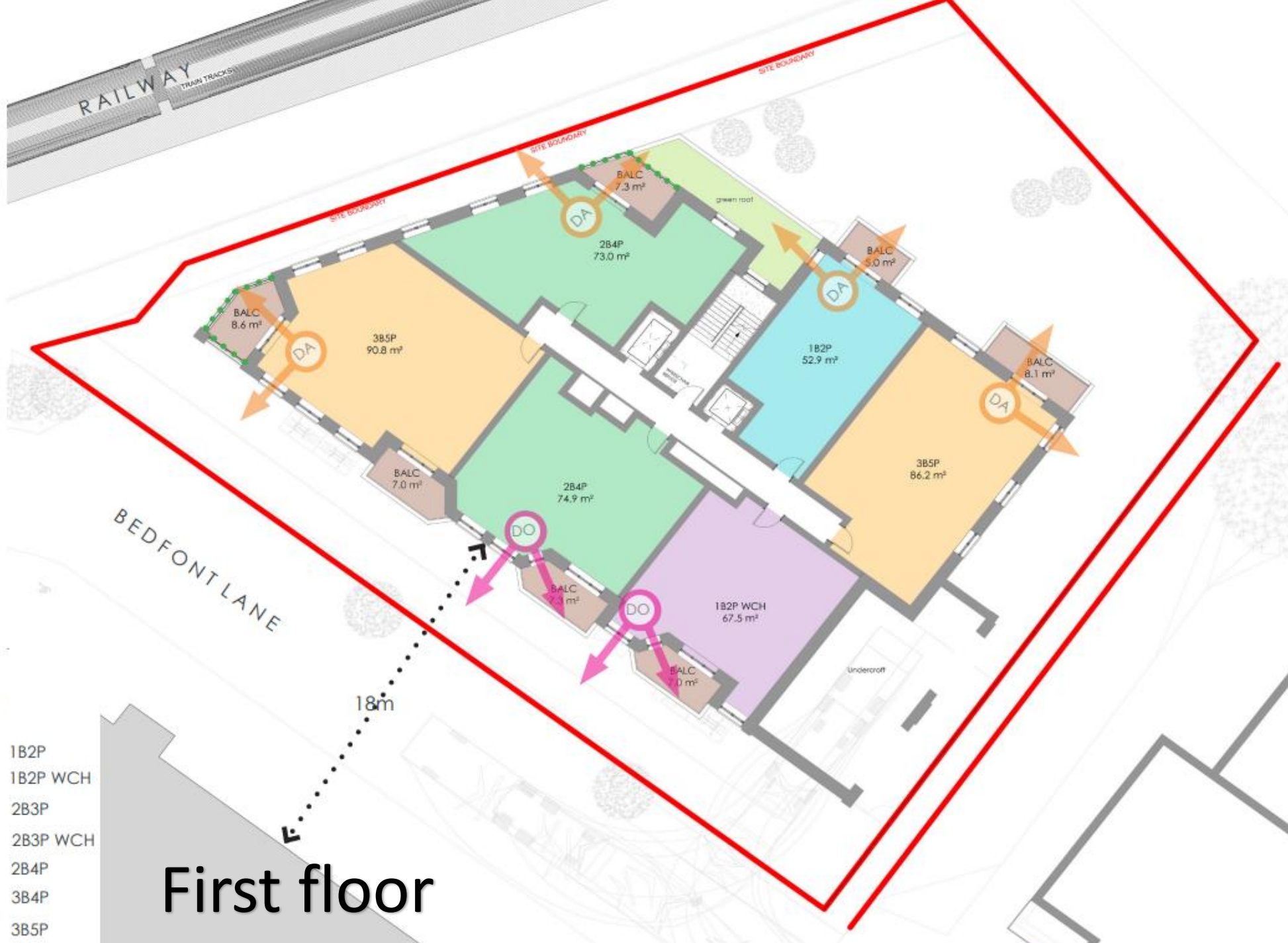

Key

- 1B2P
- 1B2P WCH
- 2B3P
- 2B3P WCH
- 2B4P
- 3B4P
- 3B5P



n



RAILWAY

BEDFONT LANE

18m

6th & 7th floors

Key

- 1B2P
- 1B2P WCH
- 2B3P
- 2B3P WCH
- 2B4P
- 3B4P
- 3B5P









Key

- 1B2P
- 1B2P WCH
- 2B3P
- 2B3P WCH
- 2B4P
- 3B4P
- 3B5P

9th to 11th floors

| Type | No. | HRs | % By unit |
|--------------|-----------|------------|------------|
| 1B 2P | 30 | 60 | 42 |
| 1B2P WCH | 1 | 2 | |
| 2B 3P | 6 | 18 | 44 |
| 2B 3P WCH | 6 | 18 | |
| 2B 4P | 20 | 60 | |
| 3B 4P | 4 | 16 | 14 |
| 3B 5P | 6 | 24 | |
| TOTAL | 73 | 198 | 100 |







feltham works









4 bedfont lane

**Delivering much
needed new housing
for Hounslow**

**A good proportion
of affordable homes**

**Promoting sustainable
methods of transport**

**New commercial space
on the ground floor**

**Creating new
landscaping areas**

**Improvements to the
footpath to the station**