



PROJECT NEWSLETTER - JULY 2025

Welcome to our project newsletter about the works taking place for new Supported Independent Living Accommodation in Coveham. Construction works have commenced to deliver new homes as part of Surrey County Council's "Right Homes, Right Support Programme".

We will continue to publish regular newsletters throughout the project to provide progress updates and also inform you of movements in and around the construction site. Visit the Community Engagement website for the project here: <https://covehamsil.communityuk.site/>

What's the project about?

This Supported Independent Living scheme has been designed to allow working age adults with a learning disability and/or autism to maintain or develop their independence and be part of the community. The overall aim of the scheme is to provide sensitive, specialist residential accommodation, which is much needed in the local area.

Currently, there are limited options for suitable accommodation in Surrey. This means that a significant percentage of working age adults supported by Surrey County Council's Adult Social Care (ASC) team are placed out of county. These individuals are therefore distanced from their family and their social care professionals (Social Workers).

Enabling people to return to and live in Surrey would reduce the need for their families and Surrey County Council professionals to travel as far (often in a car) to maintain personal contact.

What's been happening so far?

We are pleased to report continued progress on site as both apartment blocks have now reached roof level. Roofing finishes have been completed on the South Block, while works on the North Block roof are well underway and progressing well.

Achieving watertightness on the roofs has been a major milestone, as it has allowed internal fit-out works to begin. Inside both of the blocks, the screeding works are now complete, and the installation of internal partitions is ongoing.

First fix mechanical and electrical works are also in progress. In addition, the mortar silo located near the vehicle entrance was successfully removed at the end of June, helping to clear space for the upcoming external works.

What's happening next month?

Looking ahead to July, we will begin removing the top lift of scaffolding from both apartment blocks to enable window installation to commence mid-month.

Once the first-floor windows are in place, we aim to fully strike the scaffolding around both blocks, offering a clearer view of the finished buildings. Internally, fit-out works will continue across both buildings. We are targeting the end of July for the start of plastering.

Externally, groundwork has now begun on the UKPN substation.

APARTMENT ROOF



EXTERNALS



INTERNAL WORKS



MEET THE TEAM



William Eddy
Project Manager
weddy@neilcott.co.uk

CONSTRUCTION SITE PLAN

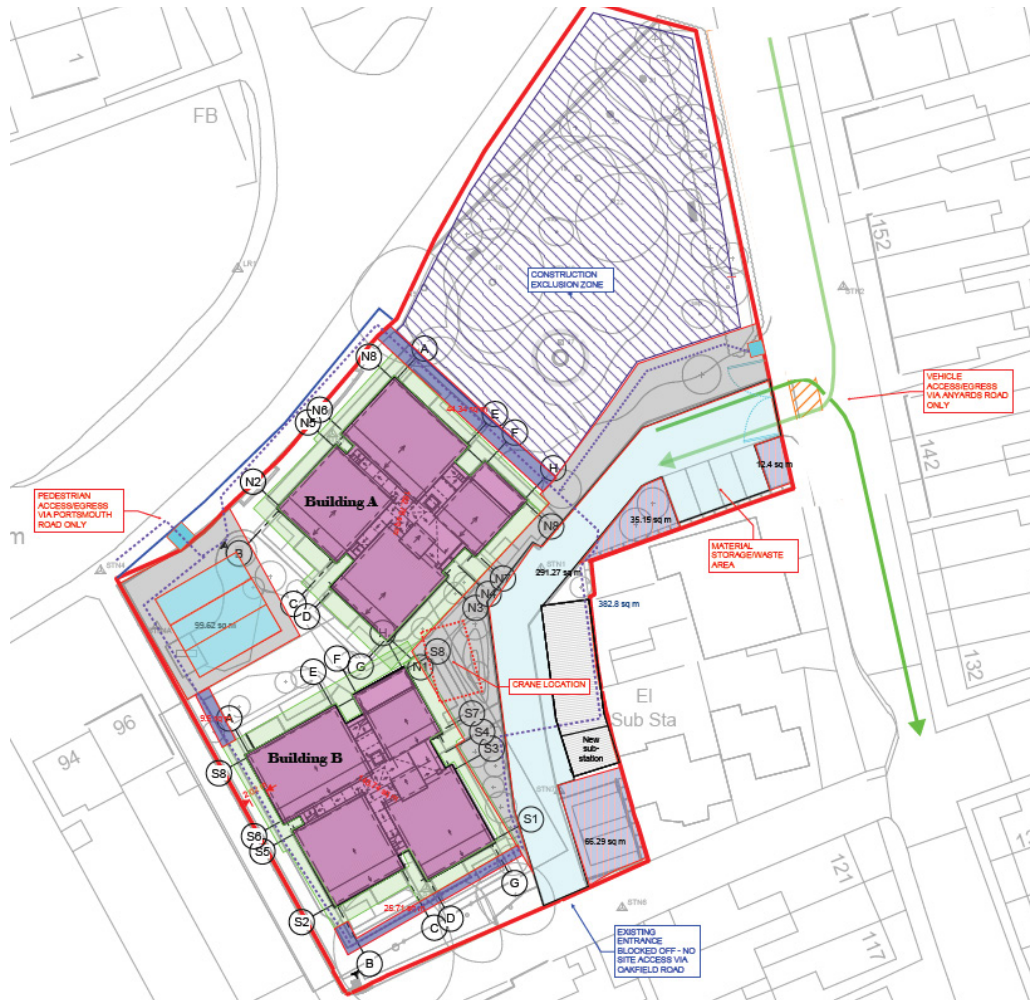

We would like to take this opportunity to thank you, our surrounding neighbours for your continued patience throughout the construction period. Should you have any questions or concerns relating to the site activity, please contact a member of our team.

Our site is registered with the Considerate Constructors Scheme. It is monitored by an experienced professional who assesses our performance against the Code of Considerate Practice, which aims to minimise the impact of construction on the community.

If you have a concern or feedback about our construction activities you can call the CCS on 0800 783 1423 or visit the website at Considerate Constructors Scheme - Public - Get In touch

REGISTERED
SITE

CONSIDERATE
CONSTRUCTORS
SCHEME